



Roxy Rose
0726520893
roxyrose@dpg.co.za

Contact Meyerton

016 0042352

24 Glynn Street
Rothdene,
Meyerton,
1961



Web Ref DPR21561

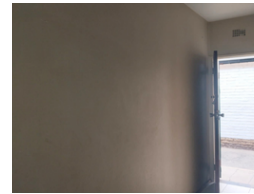

R450,000

2 1

Monthly Bond Repayment R4,492.71

Calculated over 20 years at 10.5% with no deposit.

Transfer Costs R17,984.00 **Bond Costs** R12,935.00

These calculations are only a guide. Please ask your conveyancer for exact calculations.

Monthly Levy R1,790 **Monthly Rates** R380

Flat with a Popular Address

2 Bedroom flat in a very popular and sought after area. This flat has the perfect location in town center. Situated in the middle of shops, schools, doctors and places of worship. Perfect for a young couple or as an investment with long term returns. Offering 2 bedrooms, both with built in cupboards there is ample storage. The compact yet modern bathroom offers a shower, basin and a toilet.

The open plan lounge lets in plenty of light. The kitchen has fitted cabinets and has loads of cupboards ensuring easy storage. The flat is tiled making cleaning a breeze. The small yard is a blank canvas for you to create your own little haven of serenity. A dedicated covered parking spot is available...just for you! This block of flats is very safe and secure offering peace of mind. Don't delay, this is a very neat and well...

Features

Interior

Bedrooms	2
Bathrooms	1
Kitchens	1
Recep. Rooms	1
Furnished	No

Exterior

Carports / Parkings	1
Security	Yes
Pool	No
Views	False

Sizes

Floor Size	62m²
------------	------

