



Valencia Mkhathshwa
061 021 3704
valencia.m@dpg.co.za

Contact Witbank
013 6961507

5 Woltemade Street,
Witbank Ext 5,
1035



Web Ref DPR16368

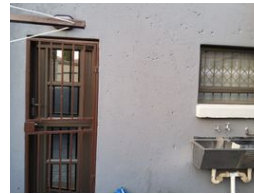

R2,500,000

4 2 2

Monthly Bond Repayment R24,959.50

Calculated over 20 years at 10.5% with no deposit.

Transfer Costs R115,861.00 **Bond Costs** R38,415.00

These calculations are only a guide. Please ask your conveyancer for exact calculations.

When you only have to view the best.

This house is in an upmarket complex in Reyno Ridge. Don't waste your time, grab the keys.

This modern double storey home offers a modern kitchen, four bedrooms, two bathrooms, three living areas, an outside room and a double garage.

It is close to all amenities. Please don't hesitate to call me for viewing.

Features

Pets Allowed Yes

Interior

Bedrooms	4
Bathrooms	2
Kitchens	1
Recep. Rooms	3
Furnished	No

Exterior

Garages	2
Carports / Parkings	1
Security	Yes
Dom. Accom.	1
Pool	No
Views	False

